

### 1 Our sincere gratitude

**Takeway® T11** clamp tripod is the best solution to most of the light tripods which lack in stability and strength. **Takeway® T1** is light and easy to carry without losing its function. The clamping and standing functions provided by **Takeway® T1** can be easily used on most consumer electronic products, such as a **DSLR**(see 6-2). With the accessory installed, it can also be used on a **smartphone** (see 6-3). It is convenient to use and creates more possibilities. **Takeway® T1** only weighs 200g, and the load capacity of ballhead is 3kg. Its portability allows it to be carried in general bags. You can enjoy its convenience no matter where you are.

### 2 Please test the relevant components and read the responsibility statement before using this product

Before using this product on your DSLR or smartphone, please check **Takeway® T1** clamp tripod and its accessories for damage or deformity. If there are any, please contact the salesperson to exchange your product to prevent damage to your consumer electronic products or personal injury caused by the flawed product. The company takes no responsibility and assumes no liability for the loss or inconvenience caused by user's own negligence.

### 3 Product components

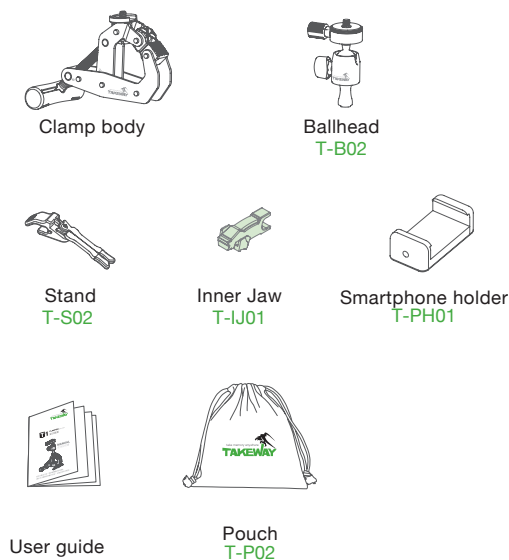

### 4 Operation notes

4-1: When using on a flat surface, use the grid side of the clamp for stability or use the smooth side of the clamp to protect the surface from damaging.

4-2: The body of the clamp is made of aluminium alloy, but do not place the product in a humid environment for a long time to avoid the product being damaged.

4-3: Do not place the product near heat or open flames which will damage the plastic components.

4-4: If the product has not been used for a long time, please check the components and functions work normally, so that it does not fall when it is used on the electronic products.

4-5: When shooting in standing position, please make sure that the tripod stands firmly on a flat surface.

4-6: After the product is assembled, please place it on a flat surface to check for its stability. When using this product for standing shooting, do not remove your hands from your electronic product when installing it on the clamp. Make sure that the clamp stands firmly on the surface before shooting, so that your electronic product will not be damaged caused by the fall of the clamp.

4-7: When shooting in standing position, please make sure the angle of the ballhead can still maintain the balance of the standing clamp. If you need to use a wider angle, please use the clamping function to prevent it from falling.

4-8: Please use this product with the following procedure. First stabilise the clamp, then mount your electronic product on the ballhead with the quick release clip, so that your product will not fall or drop caused by negligence.

4-9: **When opening the clampod jaw to the max opening 50mm, it will feel a little tight. STOP SCREWING ON!! Otherwise the clampod might be damaged. The company takes no responsibility to the damage from an incorrect action.**

4-10: When shooting in standing position, please adjust the camera a proper angle and keep the balance of the clamp so that it does not fall.

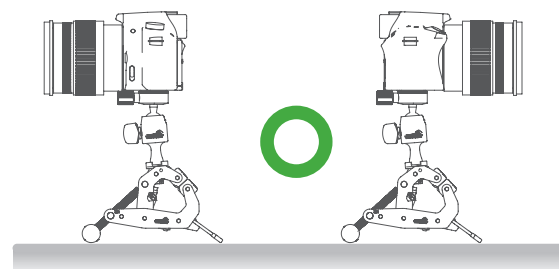

### 5 Parts name

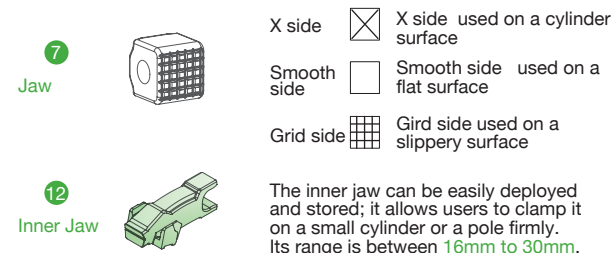
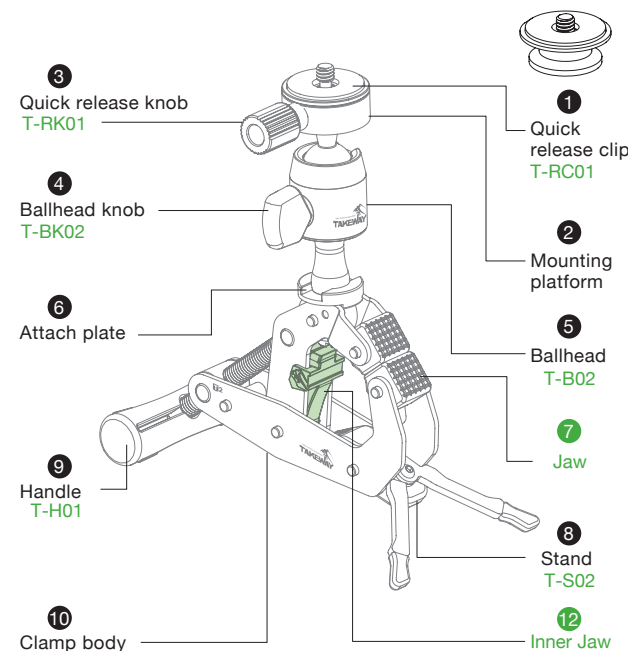

### 12 Usage of the inner jaw

The inner jaw allows users to clamp on to a small cylinder conveniently. It is made of highly reinforced plastic. It has been installed inside the clamp in production. Please do not remove this **12. inner jaw** away from the clamp for loss prevention.

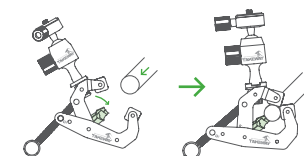

Clamping range from **16mm to 30mm**

### 6 Assemblage and operation

#### 6-1: Clamping Instruction

Don't move your hands away from your electronic device immediately right after mounting it on the clampod and clamping. Make sure that your electronic device is securely mounted to prevent your electronic device from falling.

##### 6-1-1: Small cylindrical

For cylindrical objects Ø16~Ø30 mm, the inner jaw should be pushed out. Then use the jaws and the inner jaw to make a "3-point clamp"

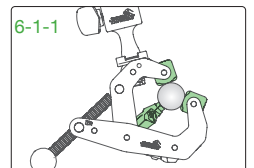

##### 6-1-2: Large Cylindrical

For cylindrical objects Ø 31~50 mm, the inner jaw should be in its stationed position. Use only the clamp body and make sure that the clamped object is completely wrapped inside the clamp body.

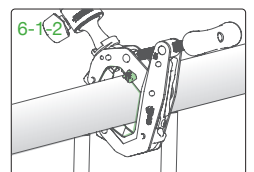

##### 6-1-3: Board/Plate

Clamping range: 1~50mm  
Use only the jaws for clamping

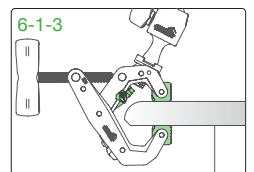

#### 6-2: Mount a digital (SLR) camera

6-2-1: Release **3**. Quick release knob, and remove **1**. Quick release clip.

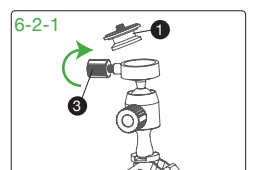

6-2-2: Screw in **1**. Quick release clip on your digital (SLR) camera with a coin or a flathead screwdriver. Please make sure that the quick release clip is screwed in tightly so that the camera does not come loose from it.

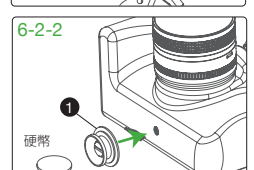

6-2-3: Choose a proper side of **7**. Jaw and clamp the tripod on a proper location. After it is done, shake the clamp gently to make sure it is fixed tightly so that it does not drop.

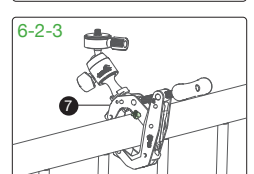

6-2-4: Mount **1**. Quick release clip with the camera on **2**. Mounting platform, and screw in **3**. Quick release knob. When shooting, please use **4**. Ballhead knob to rotate the camera freely in 360°. Adjust the camera to a proper position and you can start shooting.

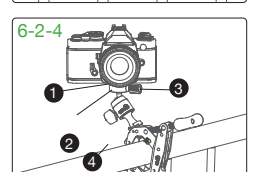

### 6-3: Mount a Smartphone

6-3-1: Release ③ . Quick release knob, and remove ① . Quick release clip.

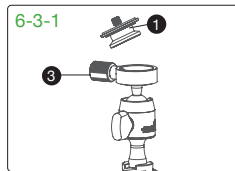

6-3-2: Before shooting, screw in ① . Quick release clip on the side of the smartphone holder with a coin or a flathead screwdriver. Please make sure that the quick release clip is screwed in tightly so that the phone does not come loose from it.

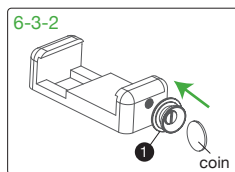

6-3-3: Choose a proper side of ⑦ . Jaw and clamp the tripod on a proper location. After it is done, shake the clamp gently to make sure it is fixed tightly so that it does not drop.

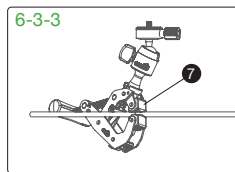

6-3-4: Mount ① . Quick release clip with the Smartphone on ② . Mounting platform, and screw in ③ . Quick release knob. When shooting, please use ④ . Ballhead knob to rotate the camera freely in 360°. Adjust the phone to a proper position and you can start shooting.

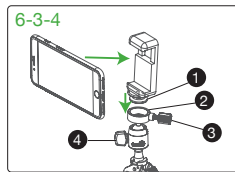

6-3-5: Before reading or playing videos, screw in ① . Quick release clip on the back of the Smartphone holder with a coin or a flathead screwdriver. Please make sure that the quick release clip is screwed in tightly so that the phone does not come loose from it.

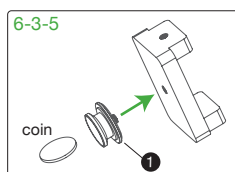

6-3-6: Mount ① Quick release clip with the Smartphone on ② Mounting platform, and screw in ③ Quick release knob. When shooting, please use ④ Ballhead knob to rotate the camera freely in 360 degrees, Adjust the phone to a proper position.

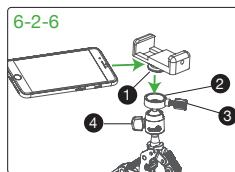

6-3-7: When reading or playing videos, please use ④ . Ballhead knob, which is able to rotate the phone freely in 360°, to adjust the phone to a proper angle for reading or playing videos. If you are using the clamp in standing position, please keep the balance of the clamp so that it does not fall.

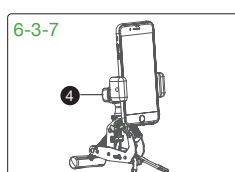

### 6-4: Installing and using ballheads of different brands

(When using a ballhead of a different brand, please ensure the load capacity of the ballhead) \*Before you start, we do not suggest shooting in standing position when a heavy ballhead of different brand is installed on the clamp, so that the clamp does not fall because of off-balance.

6-4-1: As Fig. 3 shows, remove the original ⑤ . Ballhead from the clamp with a flathead screwdriver. Install a ballhead of a different brand and screw in tightly. \*For different ballheads, the size of the screw might be different as well. Some large ballheads will require a 1/4" -> 3/8" screw adapter. Please check the screw size of your ballhead before installation .  
Fig. 3

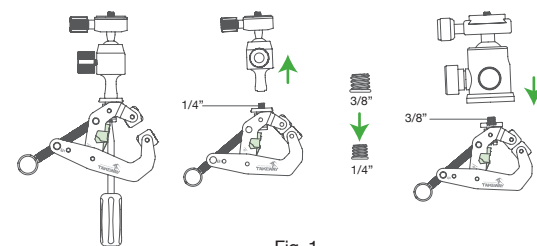
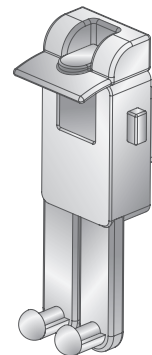

Fig. 1

### 6-5: Optional Accessories

#### T-TH01 Tablet Holder

T-TH01 connects to T2 by the 1/4" screw hole. Used for tablet PCs or larger smartphones. The largest available width of tablet is approximately 22 cm (approximately 12-inch tablet, iPad Pro 12.9-inch is acceptable) and 800g (1.76pounds).



#### T-PH03 Phone Holder For Sports

(including T-AP02 V belt) Covered design. This can be used in a dynamic environment. Even strong vibration will not easily cause this device to come loose. Appropriate for 4-6 inch smartphones.



#### T-FN01 Flex Neck

Connecting T-TH01 tablet holder or T-PH03 smartphone holder with main products.

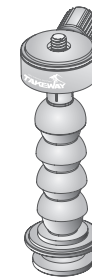

## 7 Specification of the product

Model number: T2 Clampod

Specs: Clamp body x 1, ballhead x 1, smartphone holder x 1, pouch x1, stand x1, inner jaw x1.

Size: Extended:16.8\*14.9\*3.1 cm  
Folded:14\*15.7\*3.1 cm

Weight: 207g (including ballhead)

Materials: Aerospace-grade aluminium alloy, nylon.

Screw of the quick release plate: 1/4"

Clamping range: Ø4 ~ Ø50 mm, flat surface 1-50mm

Ballhead load capacity: 3 KG

Clamp load capacity: 40 KG

\*The maximum load capacity of Takeway @ T2 clamp body is 40kg (including ballhead), but the maximum load capacity of the ballhead itself depends on its own design.

## 8 Safety warning

8-1: Please follow the operation notes. The company takes no responsibility for any man-made damage.

8-2: Please do not take your hands away from the clamp before it is fully stabilised, or your electronic product might be damaged from falling.

8-3: The product has a strong clamping force. Please do not screw too tight, so that it will not damage the clamped object.

8-4: Do not apply any volatile solvents (kerosene, paint thinner) on the product surface.

8-5: If the product is damaged or deformed from falling or impact, please stop using the product anymore, so that your electronic product will not be damaged from any malfunction.

8-6: An adult must accompany when children under the age of 12 are using the product.

## T2 CLAMPOD

Clamp Tripod

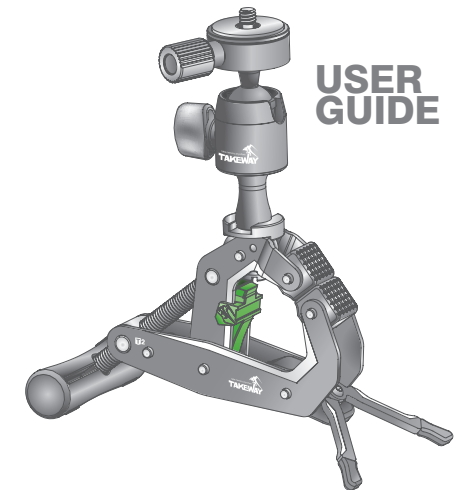

Before using the product for the first time, please read through the user guide.

Please use this product correctly after fully understanding the content of the user guide.

More user guides in different languages  
<https://www.takewayglobal.com/download.htm>



All information described in this user guide is based on the test standard of Takeway. Sorry for the inconvenience caused if there are any errors. The design and specifications of this product are subject to change without notice.

Copyright: All Rights Reserved

**EHOMA INDUSTRIAL CORPORATION**

TEL: +886-4-2406 5031  
info@takeway.tw  
www.takewayglobal.com