

Contents:

Damping foam x 2, Auxiliary installation pad x 1, Pad for sleeve corners x 2. The user can decide whether to use these accessories, based on the thickness of the phone case.

- ① Phone Holder. (T-PH05B)
 - ② Ball Base. (T-BM07)
 - ③ Damping Foams. (Including an auxiliary installation pad)
 - ④ Sleeve Pad (T-PD02)
- ③ and ④ are optional.

* If the smartphone (including phone case) is thinner than 12mm, follow the instructions and install all the accessories.

If the smartphone (including phone case) is between 12 mm and 14.5 mm thick, install the accessories at your discretion.

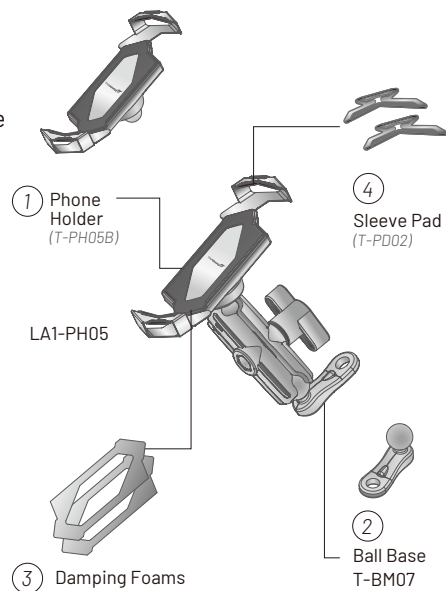

2-1: Installation of pads for both upper and lower sleeve corners :

Align the long edge of a pad with the long V-shaped edge of one sleeve and hold with one finger. Use the finger to gently push the pad's edge toward the aligned sleeve edge. The installation is finished when you hear a click, and the pad completely sits in the sleeve. Repeat the procedure for the other sleeve.

2-2: Installation of the damping foam:

The user can decide whether to use the damping foam or not, based on the phone case's thickness. Take off the releasing paper on **a** the damping foam (Figure 2). Place the combined piece on the phone holder bed.

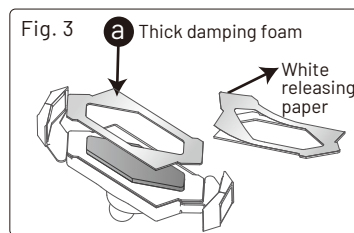
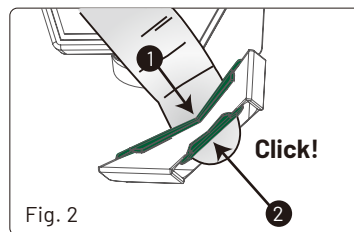
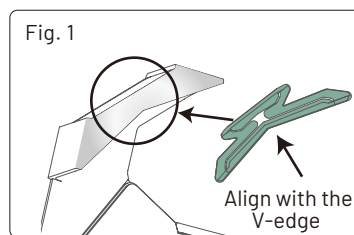

Attention!

The pads of sleeve corners and damping foams are NOT necessary to install. It depends on your phone thickness including the phone case. The most import is to make sure your smartphone seated **closely into the phone holder** before any further operation. A vacant space may increase the damage risk when riding and using the phone holder.

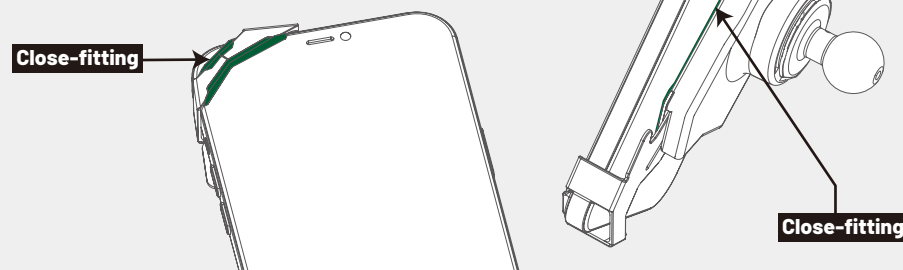

Step 1.

Loosen up the nut of the rearview mirror and keep turning the mirror until you can take it off. Insert the ball mount of LA1-PH05 into the dismantled rearview mirror and screw the mirror back to the motorcycle. You can adjust the angle of the phone holder using the knob on the bracket.

Please check the curve between the dashboard and the rearview mirror base and adjust the the ball mount accordingly to get a proper angle (front/rear). If your rearview mirror base has a 8 mm screw, please use the enclosed 8 mm washer for mounting.

Step 2.

Hold the smartphone and insert the lower right tip of the phone into the sleeve corner at the bottom of LA1-PH05. Push downward so that the upper and lower sleeve corners of the phone holder are pushed outward at the same time and there is enough space for placing the smartphone in between. Insert the upper left tip of the phone into the other sleeve corner. Make sure the upper and lower sleeve corners ① of the phone holder firmly hold the phone before letting go your hand. Slide down the smartphone smart security lock at the back of the phone holder to ensure double safeguards when you use the device on the move.

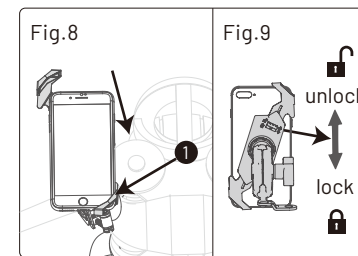
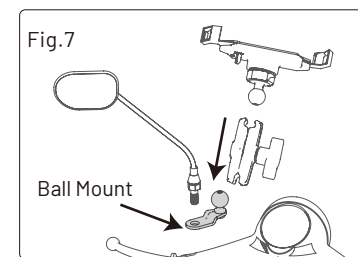

Note: When using the smart security lock, please do not put your finger between the clamping jaws (silver components) to avoid injury to your finger or compromise of the clamping strength.

5 Take out the smartphone

< Dismantling >

A Unlock the smart security lock. Use one hand to push the corner sleeves open by applying force toward the lower right corner. Once the corner sleeves are expanded, you can easily take out your phone.

B Quick release universal bracket (Anti-theft feature):
If the bracket will not be in use for a long time, you can dismantle it by using the quick release feature and store the bracket in a safe place. Instruction: Loosen the bracket knob. Take off the the ball-shaped mount of the phone holder. Use fingers to nip the top of the clamping bracket and the bracket will come off easily.

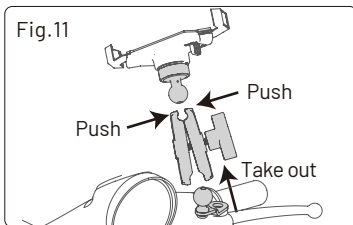
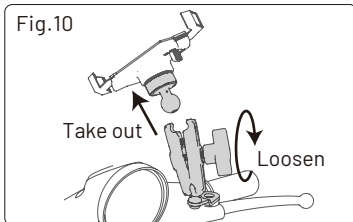

6 Mount for Action Camera

T-RC04 Quick release Ballhead for action camera

Put the action camera on T-RC04 Quick release ballhead.

- * Optional accessory: T-RC04
- * Optional accessory T-RC05

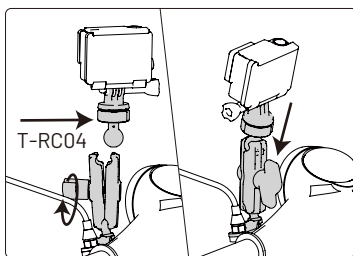
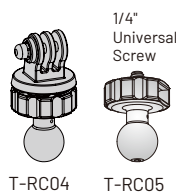
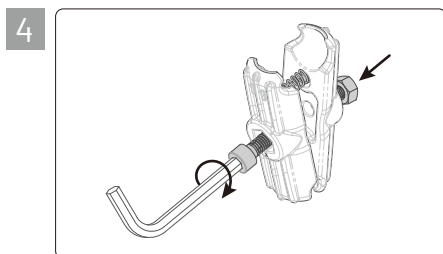
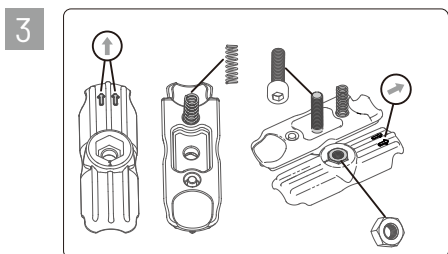
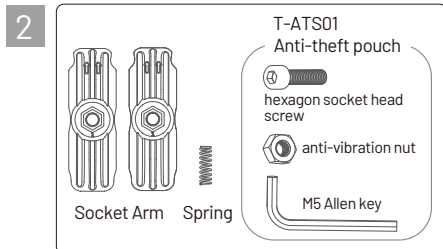
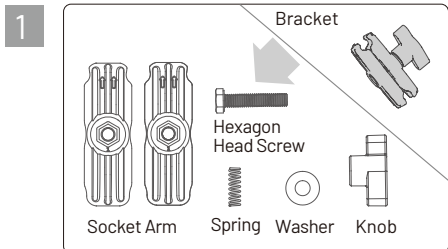

Fig.12

Optional Accessory

7 Mount For Anti-theft Instruction



Note the direction!
The circle of the anti-vibration hexagonal nut is outward.

Place and assemble the spring, the screw, and the screw nut in the right position. Use an Allen key to tighten up the screw.

8 Simple functional testing

1. Before setting the security lock, use one hand to pull down the lower sleeve corner to check whether the gliding is smooth.
2. Fasten the security lock, while keeping the sleeve corners open. Check whether the extended sleeve corners are firmly fixed and do not glide.
3. Unfasten the security lock. The sleeve corners will automatically return to their original positions.

* Inappropriate testing and use might damage the phone holder structure. Any damage due to this inappropriate handling is not covered by the standard limited warranty.

* If you have any concerns about the product use, please stop using it immediately and contact our customer service.

Customer Service E-Mail:
info@takeway.tw

9 The validity period of the standard limited warranty

The standard limited warranty is valid for one year, from the original date of purchase for a consumer or a private purchaser (the warranty covers only the primary phone holder and does not include the attached accessories).

Please be aware of this condition and use the phone holder at your discretion.

This product is covered by product liability insurance. However, any personal injury and property damage caused by misuse of and physical abuse to the product is not covered, and Takeway® takes no responsibility for such injury and damage.

Please carefully read the product manual and correctly use the phone holder.

! WARNINGS

This product is designed to reduce the vibration's impact on the smartphone. However, it does not function as optical image stabilization and cannot completely eliminate the vibration's impact on the optical lens. Please be aware of this condition and use the phone holder at your discretion.

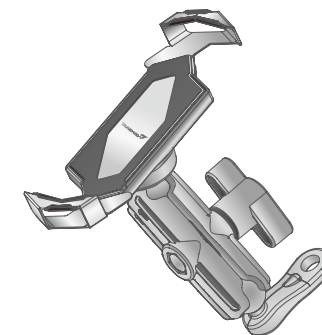

LA1-PH05 MANUAL
Z Phone Holder

Before using the product for the first time, please read through the user guide.
Please use this product correctly after fully understanding the contents of the user guide.

All information described in this user guide is based on the test standard of Takeway®. Sorry for the inconvenience caused if there are any errors. The design and specifications of this product are subject to change without notice.

*Patented product,
counterfeiting not allowed*

EHOMA INDUSTRIAL CORPORATION

TEL: +886-4-2406 5031
info@takeway.tw
www.takeway.tw